

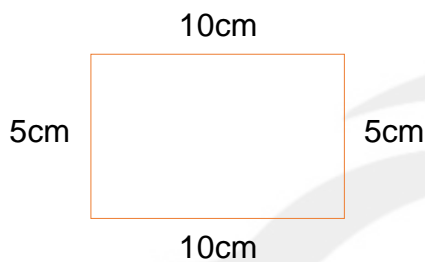

Perimeter

Finding the Perimeter

The perimeter of a shape is the distance around it.
You can find it by adding up all of the side lengths.



The perimeter of this rectangle is:

$$P = 10 + 10 + 5 + 5 = \mathbf{30cm}$$

Instructions: Find the perimeter of the shapes below.

1



2



3



4

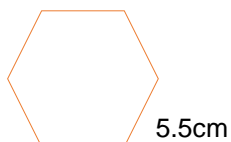



Instructions: Find the perimeters of the day-care centres below.

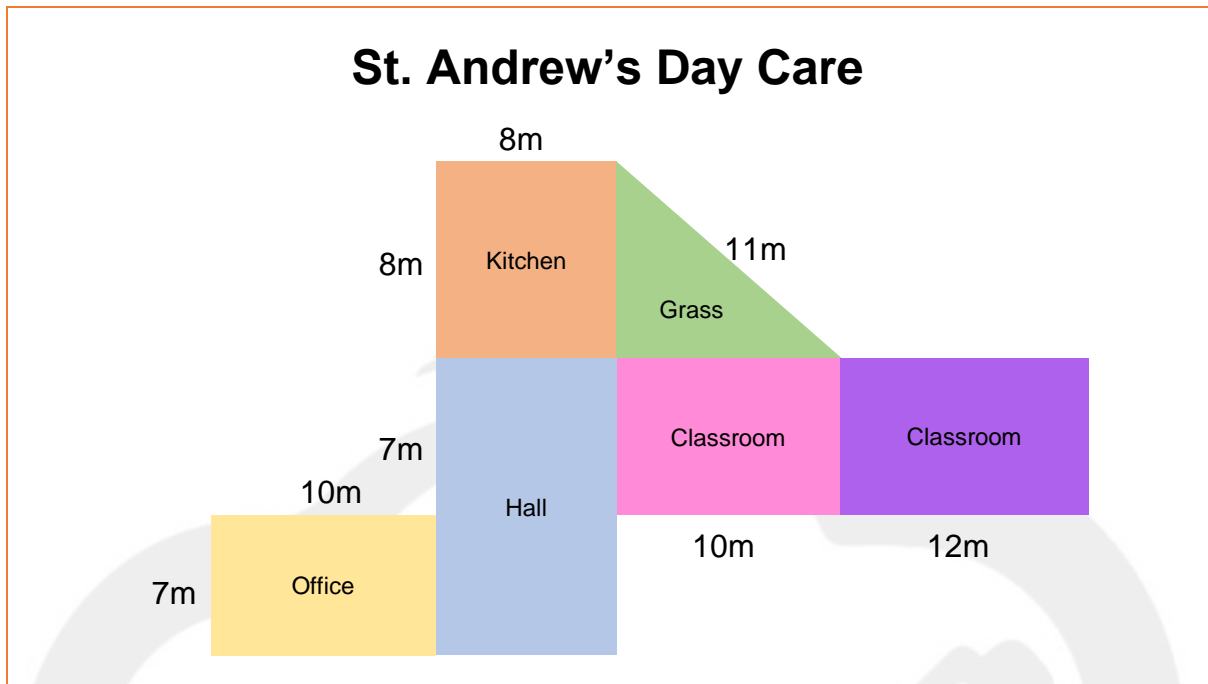

1

Find the perimeter of the office.

2

Find the perimeter of the grass.

3

Find the perimeter of the purple classroom.

4

Find the perimeter of the kitchen and hall visible from outdoors.

5

Find the perimeter of grass and pink classroom together.

6

Find the total perimeter of the day care.



Perimeter

Finding the Perimeter

The perimeter of a shape is the distance around it.
You can find it by adding up all of the side lengths.

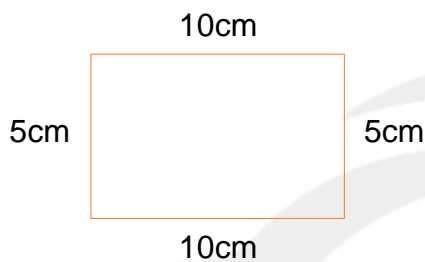

The perimeter of this rectangle is:

$$P = 10 + 10 + 5 + 5 = \mathbf{30cm}$$

Instructions: Find the perimeter of the shapes below.

1

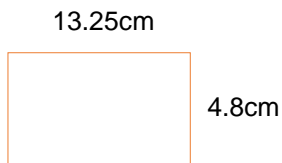

2

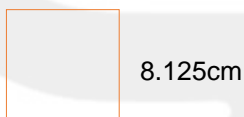

3



4



Instructions: Answer the perimeter questions below.

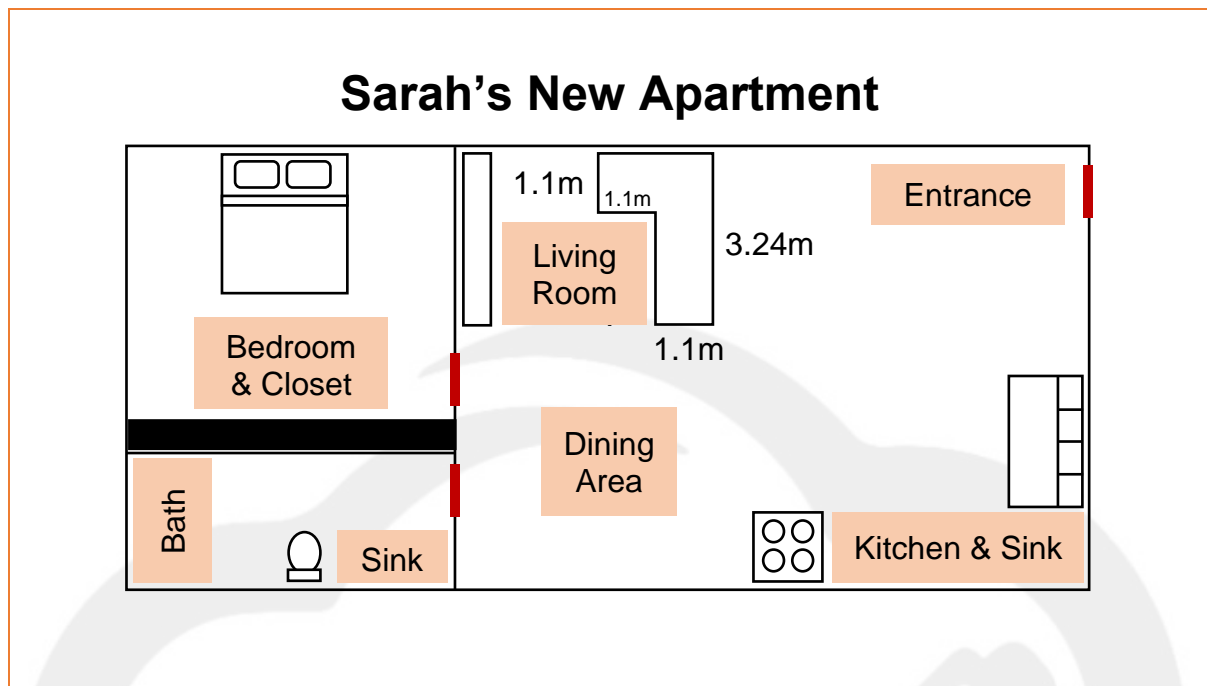

- 1 Find the perimeter of Sarah's stove if it is 1.35m wide.
- 2 Find the perimeter of Sarah's bed if it is 2.1m long and 1.89m wide.
- 3 Find the perimeter of the sofa in the living room.
- 4 Find the perimeter of the bathroom if Sarah's closet is 4.63m long and the bath is 1.75m long.
- 5 Find the perimeter of Sarah's square bedroom if the closet is 4.63m long.
- 6 Find the total perimeter of Sarah's apartment if it is 11.47m long and 6.38m wide.